

AERODROME GROUND
MOVEMENT CHART - ICAO

APRON ELEV
101 m

LISBOA ARR INFORMATION 124.155
LISBOA DEP INFORMATION 121.955

LISBOA DELIVERY 118.955
LISBOA GROUND 121.755
LISBOA TOWER 118.105

LISBOA, Humberto Delgado (LPPT)

TAXI ROUTE PROCEDURES ARRIVAL / DEPARTURE RWY 20

VAR 02° W 2020
ANNUAL CHANGE 10' E

HOTSPOT



ARRIVAL RWY 20

- Pilots should plan their landing to vacate RWY 20 via TWY "H3", in order to minimize runway occupancy time, except by agreement of ATC.
- If, for any particular reason, you wish to vacate via taxiway "A6" or "T5", make the request on first contact with TWR.

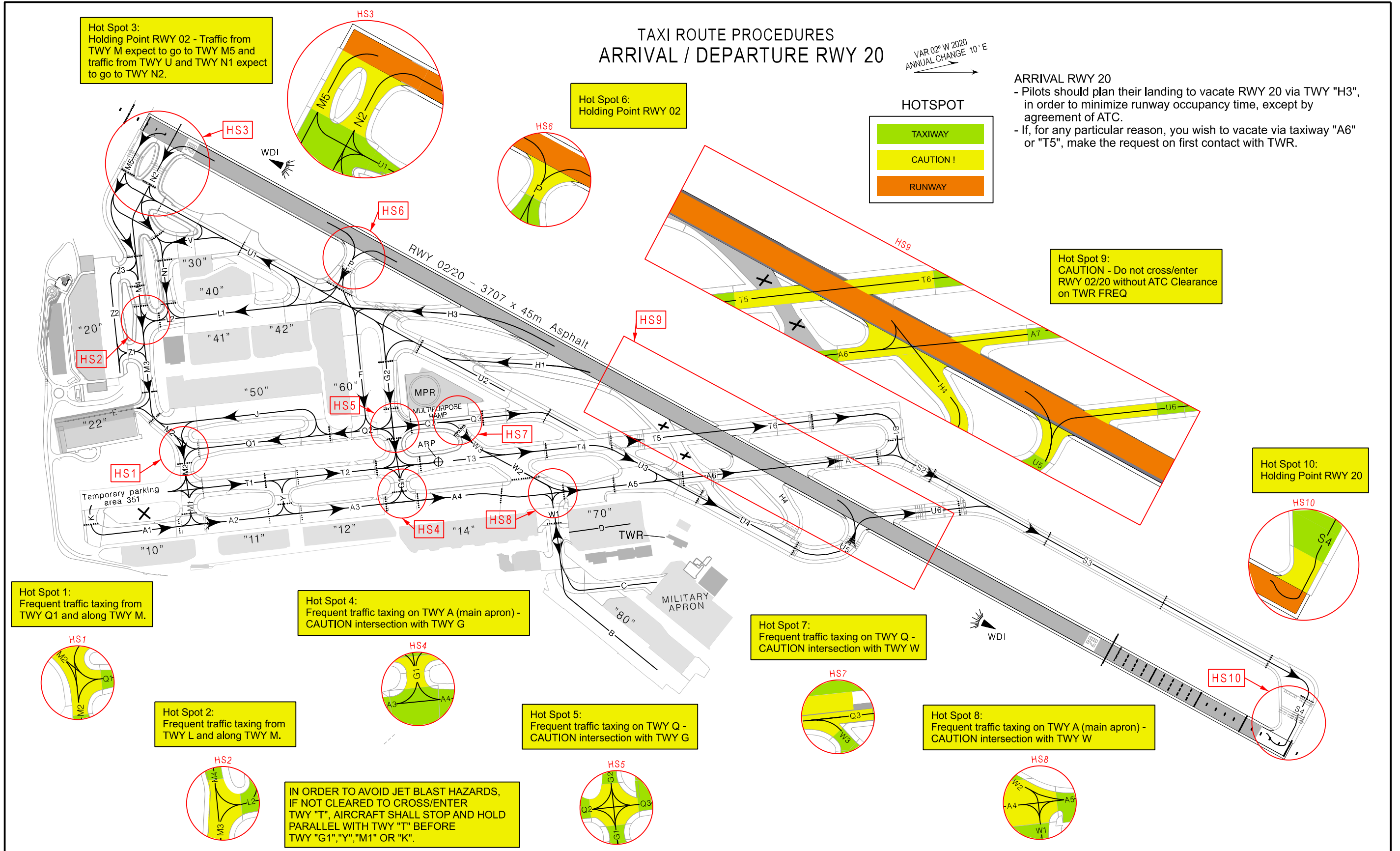

Editorial.

THIS PAGE INTENTIONALLY LEFT BLANK